



DRAWING REGISTER

DRAWING NUMBER	SHEET NAME	REV. No.	REV. DATE
12605.5 DA L001	landscape master plan	H	13/7/20
12605.5 DA L002	detail area a	H	13/7/20
12605.5 DA L003	detail area b	H	13/7/20
12605.5 DA L004	detail area c	H	13/7/20
12605.5 DA L005	detail area d	H	13/7/20
12605.5 DA L006	detail area perspectives	H	13/7/20
12605.5 DA L007	landscape images + schedule	H	13/7/20
12605.5 DA L008	landscape signage schedule	H	13/7/20
12605.5 DA L009	play space concept	H	13/7/20
12605.5 DA L010	play space images + schedule	H	13/7/20
12605.5 DA L011	design report	H	13/7/20
12605.5 DA L012	design report	H	13/7/20
12605.5 DA L013	asset protection zone	H	13/7/20

landscape development application

ST JAMES MASTER PLAN
ST JAMES PRIMARY SCHOOL
30 VISTA PARADE, KOTARA



landscape master plan | L001

Notes

1. POTENTIAL TURNING AREA FOR LARGER VEHICLES.
2. COPSED PLANTING OF CANOPY TREES IN TURF PROVIDE VEGETATED BACKDROP TO THE SCHOOL WHILE REPLACING TREES THAT HAVE BEEN REMOVED DURING THE WORKS
3. FISHING NET ESTABLISHED ON GROUND PLANE - REFER TO IMAGE AND NOTES BELOW
4. HEDGE TO WESTERN BOUNDARY TO SCREEN DRAINAGE CHANNEL
5. BIKE RACKS ON DECO GRANITE. 5 SPACES.
6. BIKE RACKS ON CONCRETE SLAB. 64 SPACES.
7. EXISTING FIELD TO BE IRRIGATED
8. EXISTING MUD KITCHEN AND PLAY AREA BENEATH TREES TO BE RETAINED.
9. PROVISION FOR VOLLEYBALL COURT FOR SENIORS
10. EXISTING PLANTING TO BE RETAINED TO FRONT OF HALL
11. LOW INTERCEPT WALL TO WESTERN BOUNDARY OF FLOOD EASEMENT. FENCE TO SIT ATOP WALL TO A MAXIMUM HEIGHT OF 1800MM
12. EXTENT OF OVERLAND FLOW CHANNEL TO BE ESTABLISHED AS AN EASEMENT FOR STORM WATER. ENTIRE PERIMETER TO BE FENCED - REFER TO FLOOD ENGN DWGS



ST JAMES JAMES WAS A FISHERMAN. GIVEN THE CLOSE PROXIMITY TO STYX CREEK THE IDEA OF A NET HAS BEEN THE BASIS FOR THE SET OUT FOR THE LANDSCAPE MASTER PLAN WHICH HAS BEEN BASED ON THE ABORIGINAL FISHING NETS. THE CENTRAL ASSEMBLY SPACE IS THE MAIN BODY OF THE NET.



ST JAMES MASTER PLAN

Legend

- EXISTING TREES TO BE REMOVED
- EXISTING TREES TO BE RETAINED
- NEW TREES
REFER TO PLANT SCHEDULE
- EXISTING LANDSCAPING
TO BE RETAINED
- SEWER EASEMENT
- HEDGE PLANTING
REFER TO PLANT SCHEDULE
- GENERAL MASS PLANTING
REFER TO PLANT SCHEDULE
- EXISTING FENCE RETAINED
- NEW 1800MM PALLISADE FENCE
- EXISTING FENCE REMOVED
- NEW 1200MM PALLISADE FENCE
- NEW TURF
- CEMENT STABILISED DECO GRANITE
- NEW CONCRETE
- EXISTING CONCRETE
- 400 X 400 CONCRETE PAVERS
- DECORATIVE BANDING
- INSTITU CONCRETE PLATFORM/WALLS
- SANDSTONE LOGS
- 1800MM SLATTED SCREEN
- OVERLAND FLOW CHANNEL - REFER ENGN DWGS
- NEW RAIN WATER TANK

H 13/7/20 updated drawing
REV DATE COMMENTS

PROJECT:
ST JAMES MASTER PLAN

SITE:
30 VISTA PARADE, KOTARA

CLIENT:
ST JAMES PRIMARY SCHOOL

12605.5_ST JAMES_DA_ISSUE G.vvwx 13/7/20

DRAWN: AL / KH DATE: 19.02.2019 SCALE: @A3

JOB NUMBER: 12605.5 DA L001 H PHASE: DWG No: REV:

1 KEY DIAGRAM
L001 Scale: 1:1000

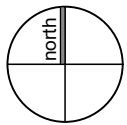

terras
landscape architects

412 KING STREET NEWCASTLE NSW AUSTRALIA 2300
TERRAS.COM.AU PH: 49 294 926 FAX: 49 263 069

detail area a | L002

ST JAMES MASTER PLAN

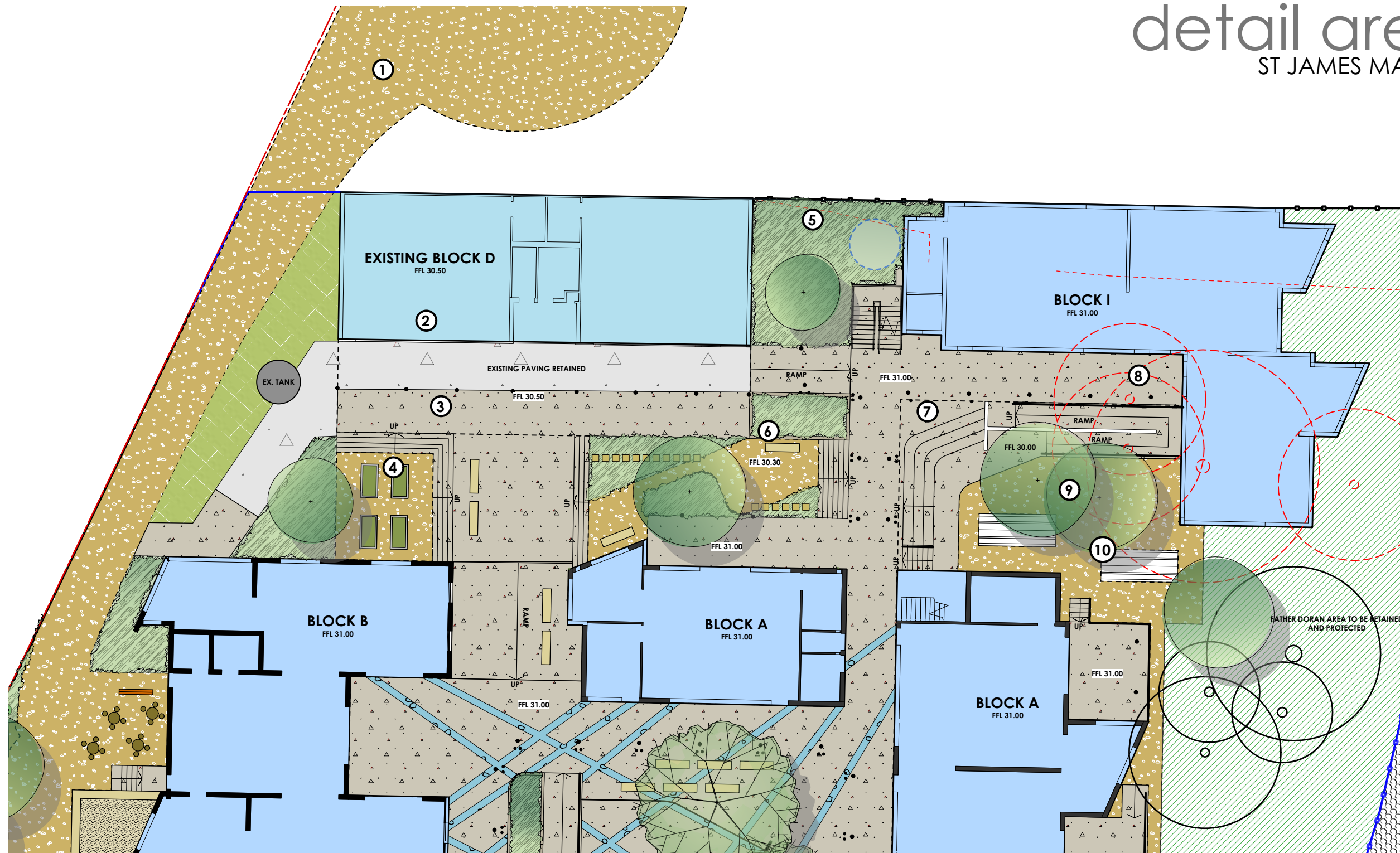

Notes

- POTENTIAL TURNING AREA FOR LARGER VEHICLES.
- EXISTING CONCRETE AREA EXTENDED TO PROVIDE OUTDOOR USABLE SPACE FOR ADJACENT CLASSROOMS. ROOF TO ALSO BE EXTENDED WRAP AROUND STEPS PROVIDE INFORMAL SEATING FOR Y6 STUDENTS
- RAISED VEGETABLE GARDEN BEDS
- FEATURE TREE PLANTING WITH MASS PLANTING OF CAREX APPRESSA AND OTHER WATER TOLERANT SPECIES
- SUNKEN SENSORY GARDEN ADJACENT TO LEARNING SUPPORT CLASSROOM
- TERRACED SEAT/STEPS PROVIDE OUTDOOR AMPHITHEATRE TEACHING SPACE
- 1:14 RAMP PROVIDES DISABLED ACCESS TO OUTDOOR LEARNING AND FATHER DORAN AREAS
- BUSHLAND WORKSPACE ESTABLISHED BENEATH CANOPY TREES LEADING INTO FATHER DORAN AREA
- LARGE OUTDOOR TABLE PROVIDES LEARNING/WORK BENCH FOR STUDENTS
- STEPS PROVIDE ACCESS FROM OUTDOOR LEARNING SPACE

A
L002 detail area a
Scale: 1:250

H 13/7/20 updated drawing
REV DATE COMMENTS

PROJECT:
ST JAMES MASTER PLAN

SITE:
30 VISTA PARADE, KOTARA

CLIENT:
ST JAMES PRIMARY SCHOOL

12605.5_ST JAMES_DA_ISSUE G.vvwx 13/7/20

DRAWN: AL / KH DATE: 19.02.2019 SCALE: @A3
JOB NUMBER: 12605.5 DA L002 H PHASE: DWG No: REV:



RAISED PLANTERS

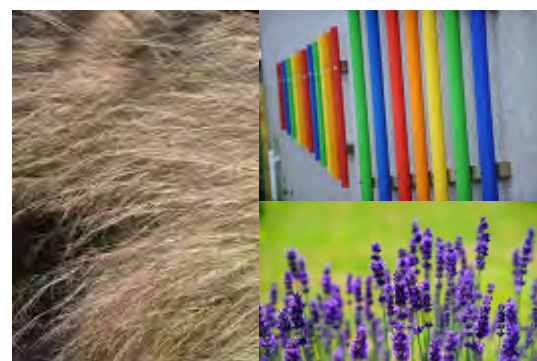

SENSORY GARDEN - SIGHT, SOUND, SMELL, TASTE, TOUCH



OUTDOOR AMPHITHEATRE



LARGE OUTDOOR TABLES FOR LEARNING

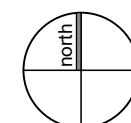

terras
landscape architects

412 KING STREET NEWCASTLE NSW AUSTRALIA 2300
TERRAS.COM.AU PH: 49 294 926 FAX: 49 263 069

detail area b | L003

ST JAMES MASTER PLAN

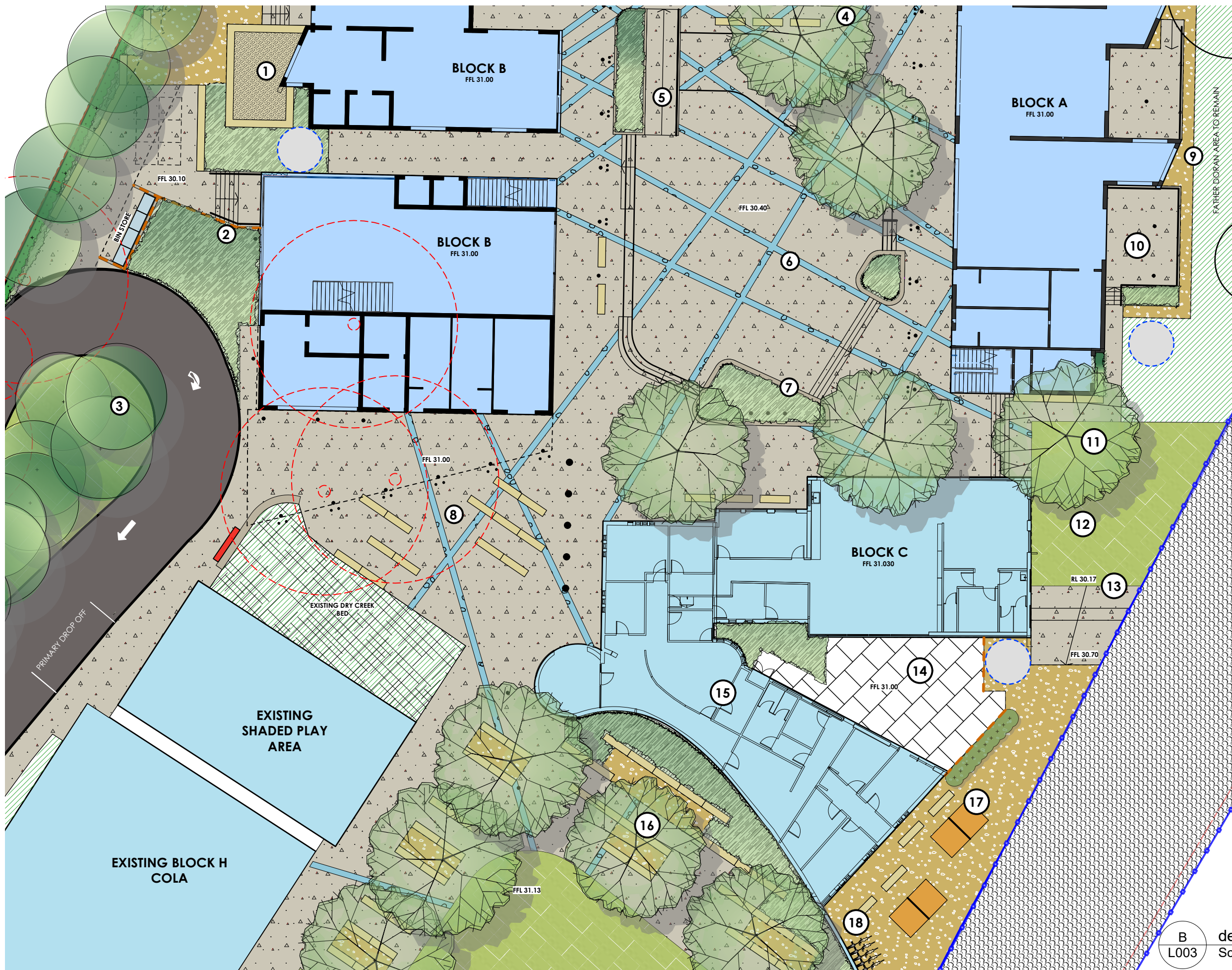

Notes

1. BREAKOUT SPACE FROM BLOCK B WITH SANDPIT (WITH COVER), SHOP FRONT AND BLACKBOARD TO CLASSROOM WALL
2. SLATTED SCREEN PROVIDES PRIVACY TO BREAKOUT AREA FROM DRIVEWAY WITH REMOVEABLE BOLLARDS RESTRICTING VEHICLE ACCESS
3. COPSED CANOPY PLANTING OF EUCALYPTUS LEUCOXYLON IN TURF PROVIDE VEGETATED BACKDROP TO THE SCHOOL WHILE REPLACING TREES REMOVED DUE TO NEW CONSTRUCTION WORKS
4. SANDSTONE LOGS PROVIDE INFORMAL SEATING SURROUNDING ASSEMBLY AREA BENEATH WALKWAY
5. RAMPED ACCESS INTO COURTYARD
6. ABSTRACTED NET PATTERN ESTABLISHED IN PAVING TO MAKE REFERENCE TO "JAMES THE FISHERMAN", WHILE CREATING INTEREST WHEN VIEWED FROM ABOVE
7. FLAG POLES
8. SCATTERED SANDSTONE LOG PROVIDE SEATING FOR 48 STUDENTS WITHIN ADDITIONAL SEATING PROVIDED ON ABSTRACTED FISH PLATFORM
9. GRAVEL ACCESS PATH FOR MAINTENANCE
10. OUTDOOR TEACHING SPACE WHICH OVERLOOKS THE FATHER DORAN AREA
11. TREE PLANTING OF ULMUS PARVIFOLIA CREATES A GREEN SPINE LEADING INTO FATHER DORAN AREA
12. REFLECTIVE LAWN SPACE FOR MUSIC/MEDITATION
13. NEW WIDE SET STAIRS PROVIDE ACCESS TO LAWN AND FATHER DORAN AREA REPLACING EXISTING DECK SPACE WHILE CREATING OUTDOOR TEACHING SPACE
14. CONCRETE PAVERS PROVIDE PRIVATE STAFF COURTYARD TO ALLOW FOR RELAXATION AWAY FROM STUDENTS WITH SLATTED SCREEN TO WESTERN BOUNDARY
15. EXISTING TIMBER WALL TO BE REMOVED WITH NEW MASS PLANTING
16. CANOPY TREES (CHINESE ELM) IN DECO GRANITE PROVIDE SHADED SEATING FOR 152 CHILDREN
17. OUTDOOR TABLE TENNIS TABLES WITH SEATING PROVIDE LEISURE AREA FOR SENIOR STUDENTS. DECO GRANITE SURFACE HELPS WITH THROUGHFARE
18. BIKE RACKS.

H 13/7/20 updated drawing
REV DATE COMMENTS

PROJECT:
ST JAMES MASTER PLAN

SITE:
30 VISTA PARADE, KOTARA

CLIENT:
ST JAMES PRIMARY SCHOOL

12605.5_ST JAMES_DA_ISSUE G.vwx 13/7/20

DRAWN: AL / KH DATE: 19.02.2019 SCALE: @A3

JOB NUMBER: PHASE: DWG No: REV:
12605.5 DA L003 H

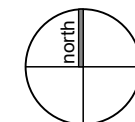

B
L003 detail area b
Scale: 1:250

terras
landscape architects

412 KING STREET NEWCASTLE NSW AUSTRALIA 2300
TERRAS.COM.AU PH: 49 294 926 FAX: 49 263 069

detail area c | L004

ST JAMES MASTER PLAN



Notes

1. LILLY PILLY HEDGE TO 2M ALONG DRIVEWAY TO SCREEN CHANNEL. EXISTING BOUNDARY FENCE TO REMAIN
2. NEW SECURITY GATE.
3. FEATURE PLANTING OF WARRATAH TREE IN DECO GRANITE BANDING CREATES INTEREST ON BUILDING ENTRY
4. MAIN ENTRY TO CHILDCARE CENTRE.
5. EMERGENCY EGRESS AND MAINTENANCE ACCESS GATE AND PATH TO CHILDCARE CENTRE.
6. SANDSTONE BLOCKS AS INFORMAL SEATING.
7. NEW FENCE TO EARLY EDUCATION CENTRE.
8. PLANTING OF ALLOXYON FLAMMEUM TREE PROVIDES NATIVE SPINE ALONG ENTRY PATH. MASS PLANTING BELOW PROVIDES SCREENING TO CHILDCARE CENTRE.
9. NEW GATE TO EXISTING FENCE.
10. NEW MASONRY SIGNAGE. REFER TO L008.
11. EXISTING FENCE TO REMAIN

H 13/7/20 updated drawing
REV DATE COMMENTS

PROJECT:
ST JAMES MASTER PLAN

SITE:
30 VISTA PARADE, KOTARA

CLIENT:
ST JAMES PRIMARY SCHOOL

12605.5_ST JAMES_DA_ISSUE G.vvwx 13/7/20

DRAWN: AL / KH DATE: 19.02.2019 SCALE: @A3

JOB NUMBER: 12605.5 DA L004 H PHASE: DWG No: REV:

C detail area c
L004 Scale: 1:250

detail area d | L005

ST JAMES MASTER PLAN



Notes

1. FEATURE PLANTING OF WARRATAH TREE IN DECO GRANITE BANDING CREATES INTEREST ON BUILDING ENTRY
2. ACCESS TO EEC KITCHEN FROM CARPARK
3. ACCESS TO EEC MAIN ENTRY FROM CARPARK
4. ACCESS TO EEC COURTYARD FROM CARPARK
5. STAFF BREAK OUT SPACE WITH PLANTING, TIMBER BATTEN SCREEN AND PERGOLA OVER.
6. PLANTING OF LOPHOSTEMON CONFERTUS TO CARPARK PROVIDES SHADE WHILE ESTABLISHING AN EVERGREEN CANOPY TO VISTA PARADE. TURF BENEATH
7. MASS PLANTING OF NATIVE GRASSES.
8. NEW GATE WITHIN EXISTING FENCE
9. FEATURE PLANTING OF CHINESE ELM PROVIDE SEASONAL INTEREST ON PEDESTRIAN ENTRY TO SCHOOL. MASS PLANTING OF GRASSES BENEATH INCLUDING POA LABILARDIERI "ESKDALE", LOMANDRA "TANKIA" AND PENNISETUM ALOPECUROIDES. SEATING BENCHES BENEATH EXTENDED PEDESTRIAN ACCESS WITH SANDSTONE LOGS PROVIDING SEATING IN SHADE AND ABSTRACTED NET PATTERN ESTABLISHED IN PAVING TO MAKE REFERENCE TO "JAMES THE FISHERMAN", WHILE CREATING INTEREST WHEN VIEWED FROM ABOVE AND LINKING TO SCHOOL SUNKEN COURTYARD AREA.
11. NEW EARLY EDUCATION CENTRE AND SCHOOL PYLON STYLE SIGNAGE WITH MASS PLANTING OF GRASSES UNDER.
12. SUBSTATION LOCATION
13. EMERGENCY ACCESS
14. LOW RETAINING WALL (REFER TO CIVIL ENGN DRAWINGS) WITH HEDGE PLANTING TO BOUNDARY TO SCREEN DRAINAGE CHANNEL AND SCREEN CARPARK FROM ADJOINING PROPERTIES TO THE WEST
15. LOW RETAINING WALL RL NOT LESS THAN 33.20 - REFER TO CIVIL ENGN DRAWINGS

H 13/7/20 updated drawing
REV DATE COMMENTS

PROJECT:
ST JAMES MASTER PLAN

SITE:
30 VISTA PARADE, KOTARA

CLIENT:
ST JAMES PRIMARY SCHOOL

12605.5_ST JAMES_DA_ISSUE G.vvwx 13/7/20

DRAWN: AL / KH DATE: 19.02.2019 SCALE: @A3

JOB NUMBER: 12605.5 DA L005 H PHASE: DWG No: REV:

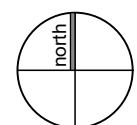

terras
landscape architects

412 KING STREET NEWCASTLE NSW AUSTRALIA 2300
TERRAS.COM.AU PH: 49 294 926 FAX: 49 263 069

D detail area d
L005 Scale: 1:250

detail area perspectives

ST JAMES MASTER PLAN

L006



VIEW ONE - NORTH ACROSS FIELD TOWARDS ADMIN BLOCK



VIEW TWO - NORTHEAST ALONG PEDESTRIAN ENTRY TO ADMIN BLOCK WITH NEW SEATING BENEATH TREES



VIEW THREE - NORTH EAST FROM SOUTH WESTERN CORNER OF CENTRAL COURTYARD



VIEW FOUR - NORTH EAST INTO NORTHERN END OF COURTYARD SHOWING SUNKEN SEATING LEVELS

H	13/7/20	updated drawing
REV	DATE	COMMENTS

PROJECT:
ST JAMES MASTER PLAN

SITE:
30 VISTA PARADE, KOTARA

CLIENT:
ST JAMES PRIMARY SCHOOL

12605.5_ST JAMES_DA_ISSUE G.vwx 13/7/20

DRAWN:	DATE:	SCALE:
AL / KH	19.02.2019	@A3

JOB NUMBER:	PHASE:	DWG No:	REV:
12605.5 DA	L006	H	

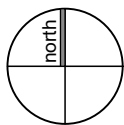

landscape images + schedule

ST JAMES MASTER PLAN

L007

HARDWORKS



OUTDOOR TABLE TENNIS TABLES



DECO GRANITE



SANDSTONE LOGS AS SEATING



SLATTED SCREEN

PLANT MATERIALS



ALLOXYLON FLAMMEUM



LOPHOSTEMON CONFERTUS



EUCALYPTUS LEUCOXYLON



ULMUS PARVIFOLIA
(CHINESE ELM)



ACMENA SMITHII 'ALLYN MAGIC'



EREMOPHILIA GLAUBRA BLUE HORIZON



CAREX APPRESSA



HIBBERTIA SPICATA OCEAN REEF



XANTHORRHOEA AUSTRALIS



HARDENBERGIA VIOLACEA



LOMANDRA TANIKA



LOMANDRA LONGIFOLIA



MYOPORUM PARVIFOLIUM



POA ESKDALE



PENNISETUM ALOPECUROIDES



WESTRINGIA FRUTICOSA MUNDI

PLANT SCHEDULE NO.1

ABB.	BOTANICAL NAME	COMMON NAME	HEIGHT	SPACING	PS
TREES					
EI	<i>Eucalyptus leucoxylon</i> var. <i>megalocarpa</i> 'Rosea'	Yellow Gum	6 x 4		75LT
LC	<i>Lophostemon confertus</i>	Brushbox	10 x 8	AS	100LT
Af	<i>Alloxylon flammeum</i>	Warratah tree	10 x 5	AS	75LT
Up	<i>Ulmus parvifolia</i>	Chinese elm	13 x 10	AS	100LT
MASS PLANTING					
	<i>Acmena smithii</i> "Allyn Magic"	Lilly Pilly	0.5 x 1	4/M2	2.5LT
	<i>Carex appressa</i>	Tall sedge	1.0 x 1.0	3/M2	2.5LT
	<i>Eremophila glabra</i> 'Blue Horizon'		0.25 x 1	1/M2	2.5LT
	<i>Hibbertia spicata</i> 'Ocean Reef'		0.5 x 0.25	6/M2	2.5LT
	<i>Lomandra</i> "Tanika"	Dwarf Mat Rush	0.7 x 0.7	6/M2	2.5LT
	<i>Hardenbergia violacea</i>	Purple Coral Pea	3 x 2	1/M2	2.5LT
	<i>Lomandra longifolia</i> (BT)	Mat Rush	1 x 1	2/M2	2.5LT
	<i>Poa labillardieri</i> "Eskdale"		0.6 x 0.5	6/M2	2.5LT
	<i>Myoporum parvifolium</i>		0.1 x 1	2/M2	2.5LT
	<i>Pennisetum alopecuroides</i>	Fountain grass	1 X 0.5	4/M2	2.5LT
	<i>Westringia fruticosa</i> "Mundi"	Rosemary	0.4 x 1.5	1/M2	2.5LT
	<i>Xanthorrhoea australis</i> (BT)	Grass tree	4 x 1.5	1.5MCTR	5LT

H 13/7/20 updated drawing
REV DATE COMMENTS

PROJECT:
ST JAMES MASTER PLAN

SITE:
30 VISTA PARADE, KOTARA

CLIENT:
ST JAMES PRIMARY SCHOOL

12605.5_ST JAMES_DA_ISSUE G.vvwx 13/7/20

DRAWN: AL / KH DATE: 19.02.2019 SCALE: @A3

JOB NUMBER: PHASE: DWG No: REV:
12605.5 DA L007 H

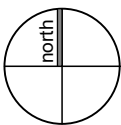

terras
landscape architects

412 KING STREET NEWCASTLE NSW AUSTRALIA 2300
TERRAS.COM.AU PH: 49 294 926 FAX: 49 263 069

landscape signage schedule

ST JAMES MASTER PLAN

L008

Signage schedule

SIGN	DESCRIPTION
A	STAFF PARKING ENTRY / EXIT
B	SCHOOL PEDESTRIAN SIGNAGE
C	EEC + VISTOR PARKING ENTRY / EXIT
D	PARKING AND DROP OFF ENTRY
E	EARLY EDUCATION CENTRE + MAIN ENTRY SCHOOL SIGNAGE
F	ECC BUILDING SIGNAGE
G	SCHOOL SIGNAGE

G - SCHOOL SIGNAGE

A- STAFF PARKING ENTRY / EXIT

B - SCHOOL PEDESTRIAN SIGNAGE

F- ECC BUILDING SIGNAGE

C - EEC + VISITOR PARKING ENTRY / EXIT

D - PARKING AND DROP OFF ENTRY SIGNAGE

EXISTING SCHOOL SIGNS TO BE REMOVED

E - PEDESTRIAN ENTRY SCHOOL SIGNAGE

1 signage
L008 Scale: 1:1000



H 13/7/20 updated drawing
REV DATE COMMENTS

PROJECT:
ST JAMES MASTER PLAN

SITE:
30 VISTA PARADE, KOTARA

CLIENT:
ST JAMES PRIMARY SCHOOL

12605.5_ST JAMES_DA_ISSUE G.vwx 13/7/20

DRAWN: AL / KH DATE: 19.02.2019 SCALE: @A3

JOB NUMBER: 12605.5 DA L008 H PHASE: DWG No: REV:

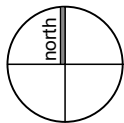

terras
landscape architects

412 KING STREET NEWCASTLE NSW AUSTRALIA 2300
TERRAS.COM.AU PH: 49 294 926 FAX: 49 263 069

PLAY SPACE CONCEPT

The play space for the childcare centre builds on the fishin net concept, yet taking on a more organic form than the school areas, picking up on the natural materials, loops and weaving forms of the net.

THE FISHING NET INSPIRES STRONG THEMES INCLUDING

- WOVEN CUBBY SPACES
- CONNECTED LOOPED PATHS
- ROPE PLAY / NETS
- WATER PLAY / CREEK
- TACTILE SURFACES INCLUDING PEBBLE PATHS
- NATURAL MATERIALS INCLUDING LOGS AND TIMBER
- LOOSE PARTS PLAY

Concrete verandah for covered outdoor play.

Artificial turf area for free play, with impact attenuation surface under to allow for play equipment to be used.

Trike / circulation paths with different ground surface materials for sensory tactile experience. All paths to be minimum 1:20 grade to allow for accessibility throughout the play space and to emergency egress points..

Formed cubby frame for climbing plants to create natural cubby.

Sandpit with sandstone logs for sitting, balancing and play. Sand retained by sandstone logs with steps at key entry points. Shade sail over.

Select feature trees to be installed in a large pot size to provide immediate vertical greenery and shade.

Low platform decks with timber balustrading behind and simple pergola structure over.

Creek to with loose rocks allow children to create channels and dams. Winds around sandpit and under path to create a variety of play opportunities. Loose parts play areas with low timber shelving for random cuts of timber, pipe and found objects.

Storage shed for trikes and gardening equipment, shared between play areas with roller shutter doors to each side. Chalk / activity board under awning to 2/3 year old area.

1800mm high platiade fence between EEC and primary school. Mass planting and trees to provide screening and additional shade.

Emergency egress / maintenance and bin storage access through 1800mm high fence with pool gate lock.



1 play space concept plan
L009 Scale: 1:200

play space concept

ST JAMES MASTER PLAN

L009

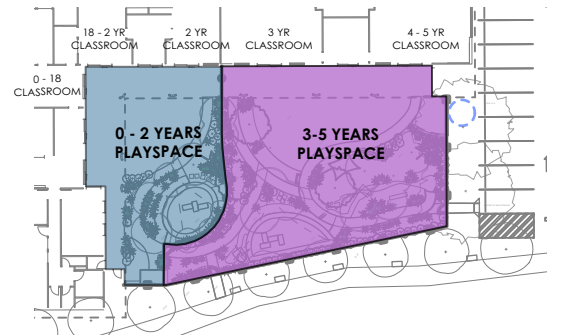

2 play space areas
L009 Scale: 1:750

Concrete verandah for covered outdoor play. Storage shed for trikes and gardening equipment, shared between play areas with roller shutter doors to each side. Chalk / activity board under awning to 2/3 year old area.

400mm high raised veggie gardens on decomposed granite. Low retaining wall as required to ensure free draining level surface.

Artificial turf area for free play, with impact attenuation surface under to allow for play equipment to be used.

Trike / circulation paths with different ground surface materials for sensory tactile experience. All paths to be minimum 1:20 grade to allow for accessibility throughout the play space and to emergency egress points..

Natural area with sensory plants, narrow winding mulch paths, stepping stones, balancing logs, climbing net and formed cubby structure with climbing plants to create natural cubby.

Mud kitchen associated with creek.

Emergency egress / maintenance and bin storage access through 1800mm high fence with pool gate lock.

H 13/7/20 updated drawing
REV DATE COMMENTS

PROJECT:
ST JAMES MASTER PLAN

SITE:
30 VISTA PARADE, KOTARA

CLIENT:
ST JAMES PRIMARY SCHOOL

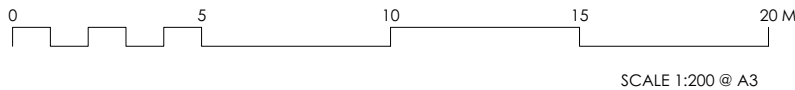
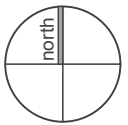

TO CREEK. 3-5 years play space AND STEPPING STONES. nature play, water play, stage and open turf area
3-5 years play space water play, circulation path and sandpit



3-5 years play space veggie garden, circulation path and open play space



0-2 years play space sandpit, circulation path and open play space



0-2 years play space sandpit, and cubby

12605.5_ST JAMES_DA_ISSUE G.vvwx 13/7/20

DRAWN: AL / KH DATE: 19.02.2019 SCALE: @A3
JOB NUMBER: PHASE: DWG No: REV: 12605.5 DA L009 H

play space images + schedule

ST JAMES MASTER PLAN

L010

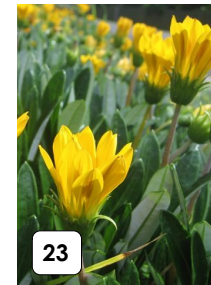
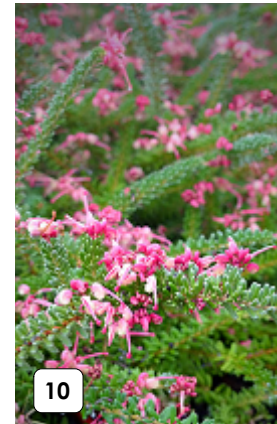
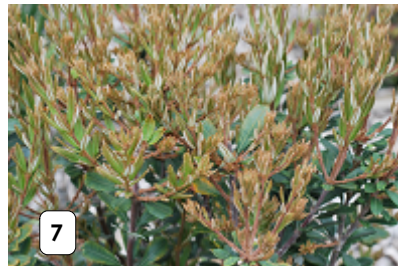

Plant list - play space

1. *Tristanopsis laurina*
2. *Banksia spinulosa* 'Birthday Candles'
3. *Hibbertia scandens*
4. *Callistemon viminalis* 'Red Alert'
5. *Rosmarinus officinalis*
6. *Stachys byzantina*
7. *Banksia integrifolia fastigiata* 'Sentinel'
8. *Ceratopetalum gummiferum*
9. *Westringia fruticosa*
10. *Grevillea lanigera* 'Mount Tamboritha'
11. *Acer palmatum*
12. *Pistacia chinensis*
13. *Pennisetum alopecuroides*
14. *Cordyline stricta*
15. *Trachelospermum jasminoides*
16. *Liriope muscari* 'Variegata'
17. *Dianella caerulea* 'Little Jess'
18. *Ajuga reptans purpurea*
19. *Asplenium australasicum*
20. *Dietes iridoides*
21. *Pandorea jasminoides*
22. *Dicksonia antarctica*
23. *Gazania tomentosa*
24. *Melaleuca linariifolia*
25. *Lomandra longifolia* 'Variegated Tanika'
26. Clumping Bamboo (non invasive)

- Water Gum
Birthday Candles Banksia
Snake Vine
Callistemon Red Alert
Rosemary
Lamb's Ear
Banksia 'Sentinel'
New South Wales Christmas Bush
Coastal Rosemary
Grevillea
Japanese Maple
Chinese Pistacio
Swamp Fox Tail
Cordyline
Star Jasmine
Liriope
Dianella
Carpet Bugle
Birds Nest Fern
White Iris
Bower Vine
Tree Fern
Silver Gazania
Snow in Summer
Variegated Tanika
Lemon Scented Gum
Deciduous Fig

H 13/7/20 updated drawing
REV DATE COMMENTS

PROJECT:
ST JAMES MASTER PLAN

SITE:
30 VISTA PARADE, KOTARA

CLIENT:
ST JAMES PRIMARY SCHOOL

12605.5_ST JAMES_DA_ISSUE G.vvwx 13/7/20

DRAWN: AL / KH DATE: 19.02.2019 SCALE: @A3

JOB NUMBER: 12605.5 DA L010 H PHASE: DWG No: REV:

SITE - GENERAL DESCRIPTION

The following landscape Design Report has been prepared in accordance with the requirements of Newcastle City Council Development Control Plan and Local Environment Plan 2012.

The site is described as Lot 12 DP 560852 and Lot 131 DP 262057 and aligns the Styx Creek. The Styx Creek becomes a formalised drainage channel just south of the site and winds north east beyond eventually feeding into Throsby Creek. A vegetation corridor aligns the Creek and surrounds the northern and eastern boundary of the site providing a vegetated backdrop to the school. Nesbit park occurs 400m to the south west of the site and Kotara West field lies 2.4km to the north east.

The site fronts Vista Parade with the existing school hall adjoining the southern boundary with the street. Excluding the School hall, the existing school buildings sit in the northern section of the site approximately 230m from Vista Parade. An informal carpark and sports field provide separation between the existing school and the street.

The school is a collection of classrooms generally focused around a central courtyard. An admin building, prefabs, cola and classrooms further north of the courtyard complete the built environment. Recent improvements to the school include a dry creek bed and bridge and an outdoor play area beneath existing trees incorporating a mud kitchen, tee pee and outdoor table and chairs.

Formalisation of the carpark and the addition of an Early Childhood Centre are proposed to the Vista Parade frontage. Additions and upgrades are proposed to the existing school buildings.

SOIL TYPE

Site soil consists of Killingworth(Ki) soil landscape, as defined by the Department of Land and Water Conservation (Matthei, 1995). The soil landscape is described as undulating to rolling hills and low hills on the Newcastle Coal Measures of the Awaba Hills region. The soils are described as shallow to moderately deep well to imperfectly drained yellow podzolic soils, yellow soloths, gleyed podzolic soils and gleyed sloths on crests and hillslopes with shallow well-drained structured loams, bleached loams and lithosols on some crests. The soils are subject to high water erosion hazard, mine subsidence, foundation hazard, seasonal water logging, sodic/dispersible soils of low wet strength, very strongly acidic soils of low fertility.

It is likely that former clearing and building works have altered the original soil material, resulting in the existing site soil being of indeterminate horticultural value. It is recommended that excavated site topsoil be tested and ameliorated to a horticultural standard and incorporated into proposed mass planted areas. Should the required standard be unachievable, then imported growing media is recommended.

VEGETATION

Vegetation associated with Killingworth soils is described as largely uncleared open-forest with some open woodland. Dominant species are Eucalyptus maculata (Spotted Gum), Eucalyptus eugenioides (Thin-leaved Stringy Bark), Eucalyptus Umbra (Bastard mahogany), Eucalyptus Fibrosa (Broad Leaved Ironbark) and Eucalyptus Paniculata (Grey Ironbark). Understorey species include Themeda australis (Kangaroo Grass), Leptospermum spp (Tea Tree) and Xanthorrhoea spp. (Grass Tree).

The majority of the site has been cleared of vegetation to make way for the school and its amenities excepting the vegetated north western corner. Most of the trees assessed on the site are native and suspected as being introduced as amenity trees with the exception of a selection of Spotted Gum, Narrow Leaved Iron Bark and Grey Gum.

A scattered planting of canopy trees occur adjacent to the existing maintenance road winding through the site. These include a mixture of Crimson bottlebrush (Callistemon citrinus), Swamp Mahogany (Eucalyptus robusta), Sydney Blue Gum (Eucalyptus saligna), Rough Bark Apple Gum (Angophora floribunda) and Snow in Summer (Melaleuca alternifolia). Three large trees, two spotted gums(Corymbia maculata) and a narrow leaved ironbark (Eucalyptus crebra) currently provide shade close to the existing admin building and a group of trees in the centre of the field including Casurina spp.(She Oak) provide shade to play elements beneath.To the north eastern boundary of the site the Father Doran area contains a group of established trees beyond which a fenced heavily vegetated area occurs. Vegetated canopy planting associated with the Styx River occurs beyond the Northern and Eastern boundary of the site.

Limited additional amenity planting occurs on site with Lilly Pillies (Syzgium) to the entry and to the central courtyard. Note worthy is a mixture of fruit trees and vegetable gardens occurring between the northern classrooms.

No street trees currently occur along Vista Parade however mass planting and juvenile tree planting exists between the hall and the boundary.

LANDSCAPE CHARACTER AND VISUAL AMENITY

The sprawling residential fabric of the suburb of kotara on low rolling topography is interspersed by green ribbons of canopy planting to the ridges and drainage corridors

Vista Parade is a typical residential street with low density one and two story housing. Views east and west of the site are of low hillsides with residential housing interspersed with canopy tree planting. Immediately south of the site lies St Philips Church Kotara which is set back from the road providing an open feel to the street adjacent to the school. Views north and south of the site are contained by the vegetated backdrop that is associated with the Styx Creek corridor.

PROPOSED DEVELOPMENT

The proposed development is for a freestanding new early education centre and alterations and additions to the existing St James Primary School. The buildings proposed are listed below.

- Early Education Centre — New Building
- Office Building Additions — Extension off existing masonry walled, metal roofed building
- Block A — Demolish existing row of classrooms and replace with new classrooms, similar footprint
- Block I — Demolish exiting classroom and build new freestanding classroom with larger footprint
- Block B — Demolish existing library and build two new freestanding buildings.

The works also include new carparking to the EEC and to the school and associated access roads.

PROPOSED LANDSCAPE WORKS AND OBJECTIVES

The priority to Vista Parade is to provide a street frontage and visible pedestrian entry for the school. A new signage wall will help to frame this entry while the widening of the entry path will help to reinforce this. It is proposed to retain the existing planting associated with the hall,with tree planting of Lophostemon confertus (Brush Box) proposed along the boundary to the carpark to establish a green canopy between the street and the ECC. Mass plating is proposed beneath. Shrub planting is proposed along the western boundary to screen views into the drainage channel. The pedestrian entry to the school with be further strengthened with feature planting of Ulmus parvifolia (Chinese Elm) aligning the hall and continuation of tree planting along the entry spine of Alloxyn flammeum (Warratah Tree).



VIEW NORTH FROM VISTA PARADE INTO SITE TOWARDS THE SCHOOL. SCHOOL HALL SEEN ON THE RIGHT (SOURCE GOOGLE JULY 2019)



VIEW SOUTH FROM SITE ALONG STYX CREEK (SOURCE: GOOGLE JULY 2019)



VIEW WEST ALONG VISTA PARADE (SOURCE GOOGLE JULY 2019)



H	13/7/20	updated drawing
REV	DATE	COMMENTS

PROJECT:
ST JAMES MASTER PLAN

SITE:
30 VISTA PARADE, KOTARA

CLIENT:
ST JAMES PRIMARY SCHOOL

12605.5_ST JAMES_DA_ISSUE G.vvwx 13/7/20

DRAWN: AL / KH DATE: 19.02.2019 SCALE: @A3

JOB NUMBER: PHASE: DWG No: REV:
12605.5 DA L011 H

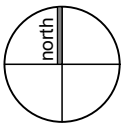

design report | L012

ST JAMES MASTER PLAN

On approach to the Admin building trees in deco granite are proposed to soften the built facade and provide seating in the shade for the forecast growth of the school. The seating is repeated to the west of the admin building.

James was a fisherman and given the close proximity to the Styx Creek the idea of a net has been the basis for the setout of the paving pattern with the assembly space being the main body of the net. Pavement paint will be used to provide the net pattern which also helps to reinforce circulation paths and create interest when viewed from above. The courtyard has been set down to creates seating to the edges and incorporate a variety of uses including accommodating large groups. Scattered canopy trees in paving will provide dappled shade within the courtyard. To the east of the admin building bike storage and an outdoor table tennis is proposed.

Between the existing admin building and the new staff room a staff courtyard is proposed for staff to relax away from the children with the northern entry to the staff room having open surveillance of the courtyard. East of here a meditation/music lawn is proposed leading into the Father Doran Garden. It is proposed to retain the existing Father Doran area with paved outdoor spaces having an elevated outlook into this quiet space adjoining the eastern classrooms.

To the north of the site between B & A and D & I blocks a variety of smaller spaces are planned with sunken areas for raised vegetable gardens, a sensory garden and also terraced seating to provide an outdoor amphitheatre with outdoor learning tables leading into the Father Doran area.

To the west of the site maintenance access is required and an outdoor space is planned for junior students incorporating a sandpit, shop front, outdoor seating in shade and handball court.

Copsed planting of canopy trees in turf provide a vegetated backdrop to the school , proposed within the primary school vehicle turning zone with the desire to replace lose trees from the proposed development and green up the western side of the school.

EARLY EDUCATION CENTRE

The early education centre is to facilitate children with an age range of 0-5 years. The playspace has been divided into two age areas- a smaller space for 0-2 years old (junior play space) and a larger area for 3-5 year olds (senior play space). The areas are separated by a palisade fence which the provider can open to share the play space as required.

The design of the outdoor play space associated with the childcare centre aims to provide a functional and interesting area with a focus on natural and non- prescribed play. The new childcare centre FFL results in a level change of upto 1.9m falling from the west to the north east. The prosed FFL of the Childcare Centre is at natural grade at the entry and is level throughout, therefore the level change occurs within the play space. The design aims to take advantage of the level change, incorporating circulation paths and play elements into the space in order to minimise fill and construction whilst ensuring accessibility throughout, both for users of the centre and to provide easy maintenance. A perimeter fence with is provided to all sides of the play space to ensure privacy, with planting to both sides to soften.

The outdoor play spaces feature the following elements:

sandpits

A sandpit has been provided to both age group play spaces with shade sails included overhead. Both sandpits have been designed with recommendations by Kidsafe and provider requirements in mind. They feature sandstone block edging as well as blocks within the sandpit to provide play and balancing surfaces.

accessibility

A curved concrete path forms the main circulation path within the play spaces, with varied play areas branching off it. The path has been designed to ensure suitable access is maintained from the finished floor level of the covered play spaces to the low point of the site, being at times upto a 1:14 grade, with handrails to be provided as needed. A maintenance gate is proposed to access the site from the lower carpark (Hunter Place) to ensure sandpits can be easily replenished and mulch topped up as required.

play elements

The playspaces both feature level turf areas adjacent to the verandah to allow for open free play. These aras are to have impact attenuation material under to allow opportunity for play equipment to be located on them. The spaces are divided by a circulation and access path, with areas beyond the turf dedicated to natural play spaces. Topographical changes are utilised to create play opportunities through nets, balancing and infomal terracing. Small decks adjoining the turf area in the 3-5 yo space and the sandpit in the 0-2 yo space and provide cubby spaces and help accomodate access and level changes.

A creek winds through the 3-5 yo play space which is to be formed in natural materials and contain loose rocks and boulders to allow children to direct water into channels and dams.

natural play

Garden beds with mass planting, tactile plants, timber balancing logs and stepping stones feature throughout the play space, softening the perimeter fencing and providing relief from hard surfaces as well as opportunity for natural play. Raised vegetable gardens are proposed to encourage gardening by the children. Dedicated loose parts play areas have been nominated, with low timber shelving.

REFERENCES

Newcastle City Council, 2012, *Newcastle City Centre Local Environment Plan*.
Newcastle City Council, 2012, *Newcastle Development Control Plan*.
Newcastle City Council, 2011, *Newcastle Street Tree Master Plan*
Matthei, L.E, 1995, *Soil Landscapes of Newcastle 1:100 000 Sheet Report*, Department of Land & Water Conservation, Sydney.
Nearmap, Accessed July 2019



VIEW EAST ACROSS FATHER DORAN AREA



MATURE TREES WITHIN CENTRE OF THE SITE



VIEW SOUTH ALONG WESTERN BOUNDARY WITH STYX CREEK



VIEW NORTH ON ENTRY TO THE SCHOOL



EXISTING COLA WITH STAGE AND SANDSTONE SEATING



MUD KITCHEN AND TEE PEE BENEATH TREES ON FIELD

H	13/7/20	updated drawing
REV	DATE	COMMENTS

PROJECT:
ST JAMES MASTER PLAN

SITE:
30 VISTA PARADE, KOTARA

CLIENT:
ST JAMES PRIMARY SCHOOL

12605.5_ST JAMES_DA_ISSUE G.vvwx 13/7/20

DRAWN: AL / KH DATE: 19.02.2019 SCALE: @A3

JOB NUMBER: PHASE: DWG No: REV: 12605.5 DA L012 H

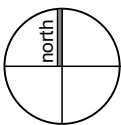

412 KING STREET NEWCASTLE NSW AUSTRALIA 2300
TERRAS.COM.AU PH: 49 294 926 FAX: 49 263 069

L013

⑤ Flood easements - refer Flood Engineers drawings

412 KING STREET NEWCASTLE NSW AUSTRALIA 2300
TERRAS.COM.AU PH: 49 294 926 FAX: 49 263 069